

## EMF Corporation LR-89

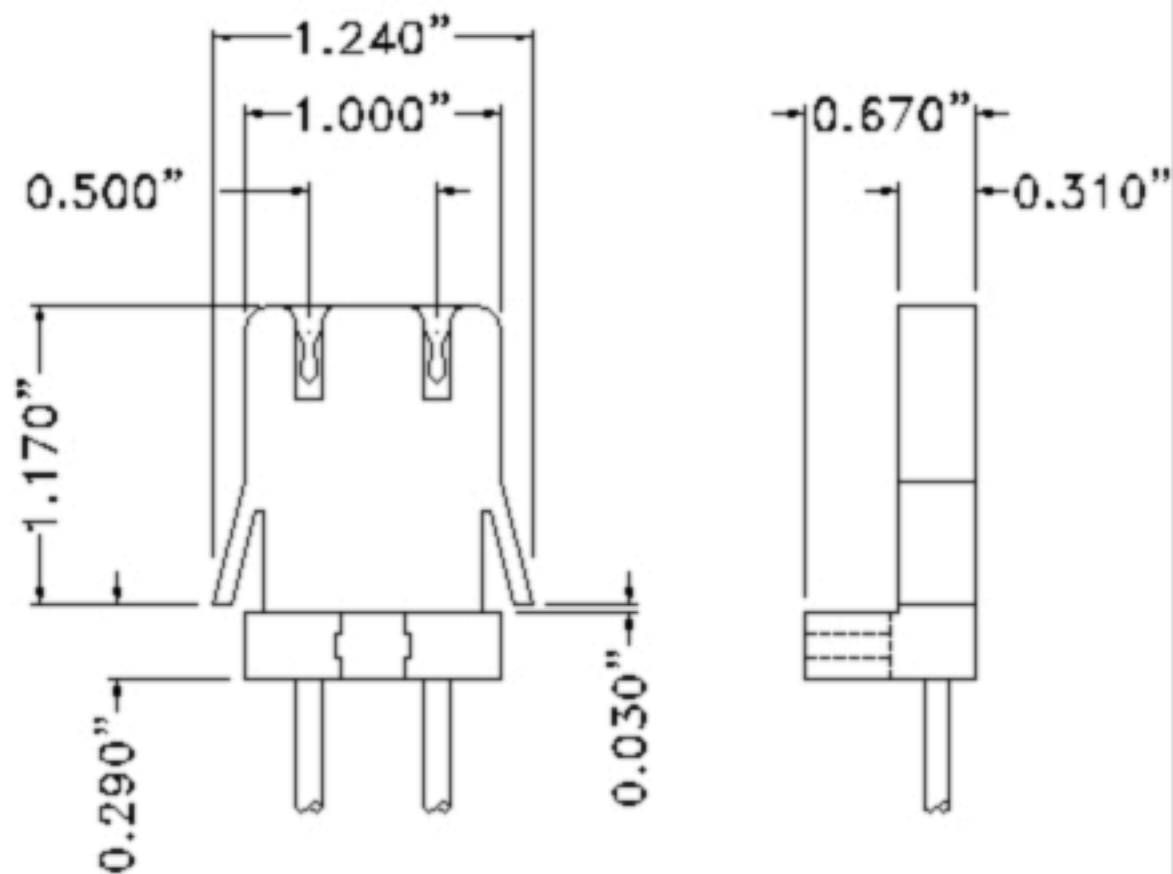

## EMF CORPORATION LR-89

### MATES

LR-88C

LR-88C-8-LED

LC-102

### POLARIZED

No

### TERMINALS

Accepts: T-8 or T-12 medium bi-pin fluorescent lamp

### DETAILS

Molded fluorescent lampholder. For T-8 or T-12 medium bi-pin fluorescent lamp. Flexible wings allow for easy installation. Available with or without mounting screw. Designed for use with mating lampholder cap and appropriate lamp safety shield.