

EMF Corporation LR-93

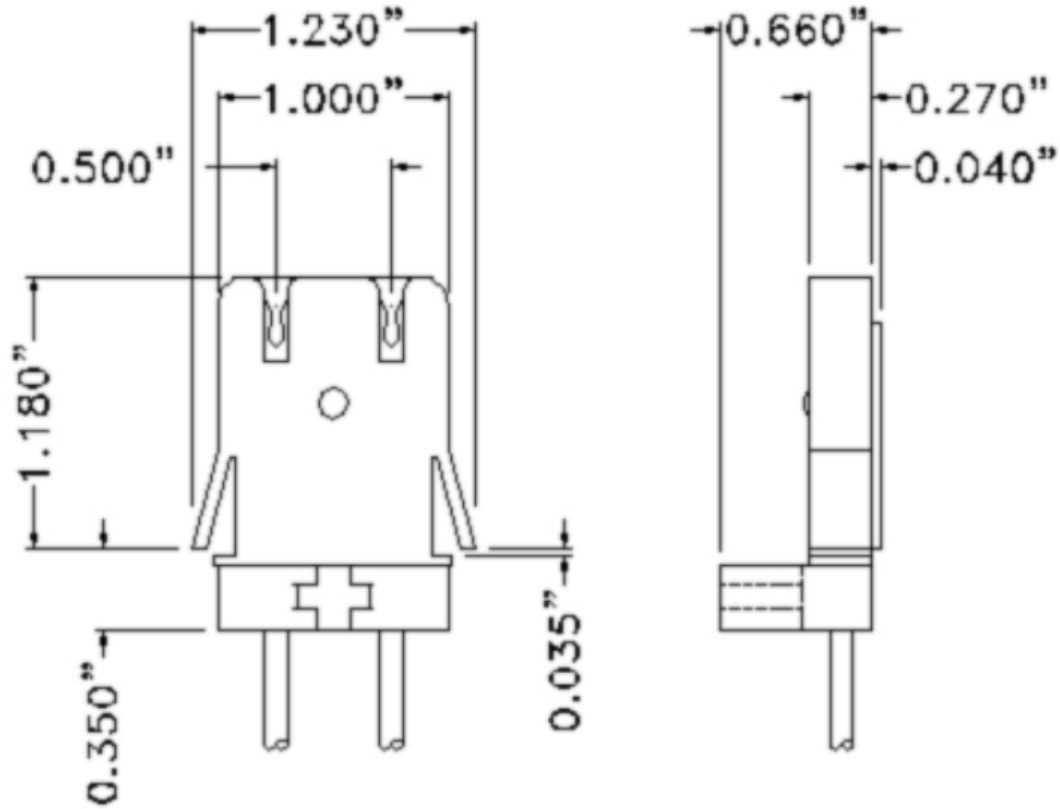

EMF CORPORATION LR-93

MATES

LR-90C
LR-90C-8
LR-90C-SP
LC-102
LR-114C

POLARIZED

No

TERMINALS

Accepts: T-8 or T-12 medium bi-pin fluorescent lamp

DETAILS

Molded fluorescent lampholder. For T-8 or T-12 medium bi-pin fluorescent lamp. Flexible wings allow for easy installation. Contains reduced profile and cap retention lock. Available with or without mounting screw. Designed for use with mating lampholder cap and appropriate lamp safety shield.