

# FLUORESCENT LAMPHOLDERS MEDIUM BI-PIN G13 FOR T-8 / T-12 LAMPS

## FL206 SERIES Low Profile, Rotary Lamp Lock



**T-8**



**T-12**



**G13**

- White polycarbonate body, rated 110°C
- Rotary type lock, low profile for T8/T10/T12 lamps
- Quick connect push-in wire terminals for 18 AWG solid wire 5/16"
- Two wire ports per terminal for easy harness wiring

- For 0.23" - 0.040" (0.6 mm - 1.0 mm) panel thickness
- Many models to choose from
- Rated 660W, 600V, suitable for all new HO lamps
- cCSAus Certified / cULus Listed



**FL206**



**FL206-BSI**



**FL206-X**

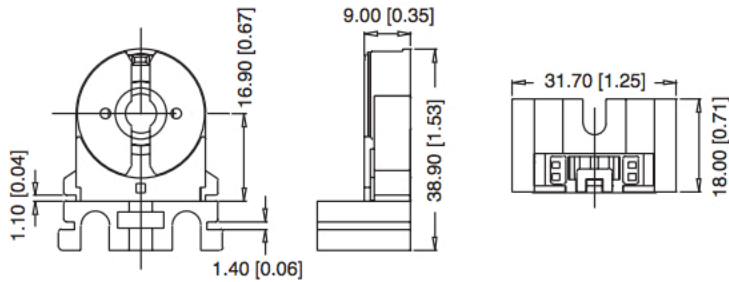
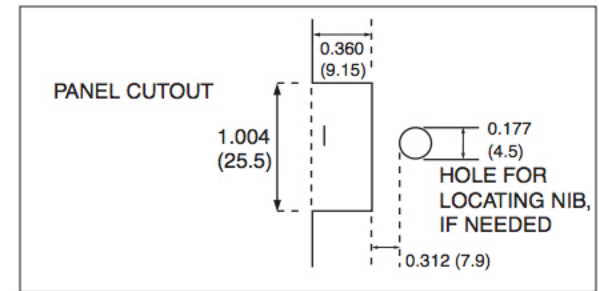

**FL206\* Δ** Solid Shoulder, Slot on Mount 18 or 20 ga. Panel, Nut Slot

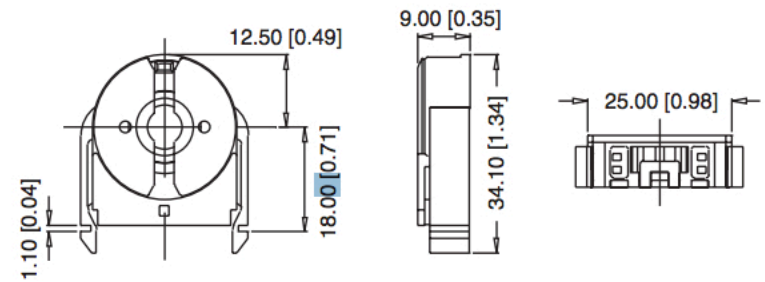

**FL206-BSI\*** Snap-in Mount from the Top

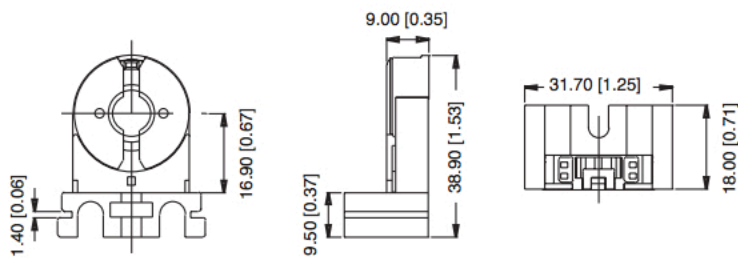

**FL206X\* Δ** Flush Sides, Slot Mount 18 ga. Panel

\* Add "-S" after product code for internal shunted version  
 Δ Add "-C" after product code for captive nut on models with nut slot